

## Disc handwheels

### Aluminium

#### SPECIFICATION

##### Bore codes

- Version **B**: without keyway
- Version **K**: with keyway

##### Aluminium

- Hub machined
- Rim turned and polished
- Unmachined body shot-blasted

Rim concentric and square to bore < 0.4

#### INFORMATION

Disc handwheels DIN 3670 have recessed grips at their back. As a rule they are supplied without handle, but the mounting of a handle is possible.

The handwheel diameter  $d_1=80$  and  $d_1=400$  are not provided in the official standard sheet.

#### TECHNICAL INFORMATION

- Keyway P9 DIN 6885 (see page A16)
- Cross holes GN 110 (see page A17)
- ISO-Fundamental Tolerances (see page A21)

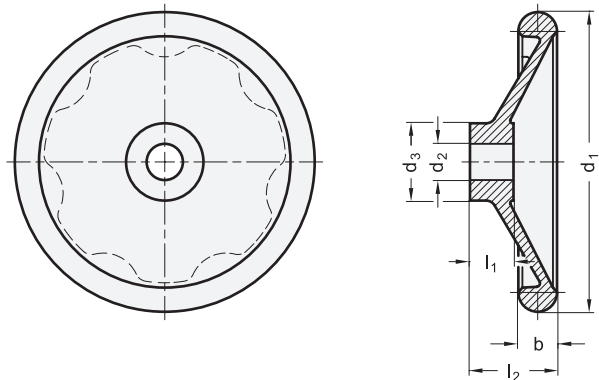

\* Complete with Bore codes of the Handwheel (B or K)

**B** without keyway      **K** with keyway

#### DIN 3670

Description	d1	d2 H7	d3	b	l1	l2 ≈	⚖
DIN 3670-80-*-10	80	10	26	14	16	29	128
DIN 3670-80-*-12	80	12	26	14	16	29	127
DIN 3670-100-*-10	100	10	28	15	17	33	188
DIN 3670-100-*-12	100	12	28	15	17	33	185
DIN 3670-125-*-12	125	12	31	16	18	36	306
DIN 3670-125-*-14	125	14	31	16	18	36	304
DIN 3670-160-*-14	160	14	36	18	20	40	514
DIN 3670-160-*-16	160	16	36	18	20	40	480
DIN 3670-200-*-18	200	18	42	22	24	45	943
DIN 3670-200-*-20	200	20	42	22	24	45	938
DIN 3670-200-*-22	200	22	42	22	24	45	934
DIN 3670-250-*-22	250	22	48	26	28	50	1608
DIN 3670-250-*-24	250	24	48	26	28	50	1596
DIN 3670-250-*-26	250	26	48	26	28	50	1582
DIN 3670-315-*-26	315	26	56	28	33	56	2695
DIN 3670-315-*-28	315	28	56	28	33	56	2689
DIN 3670-315-*-30	315	30	56	28	33	56	2683
DIN 3670-400-*-30	400	30	65	32	38	63	4370
DIN 3670-400-*-32	400	32	65	32	38	63	4342

Weight bore code B



Operating elements 1